

VOLUME 19 No. 3

JANUARY, 2006

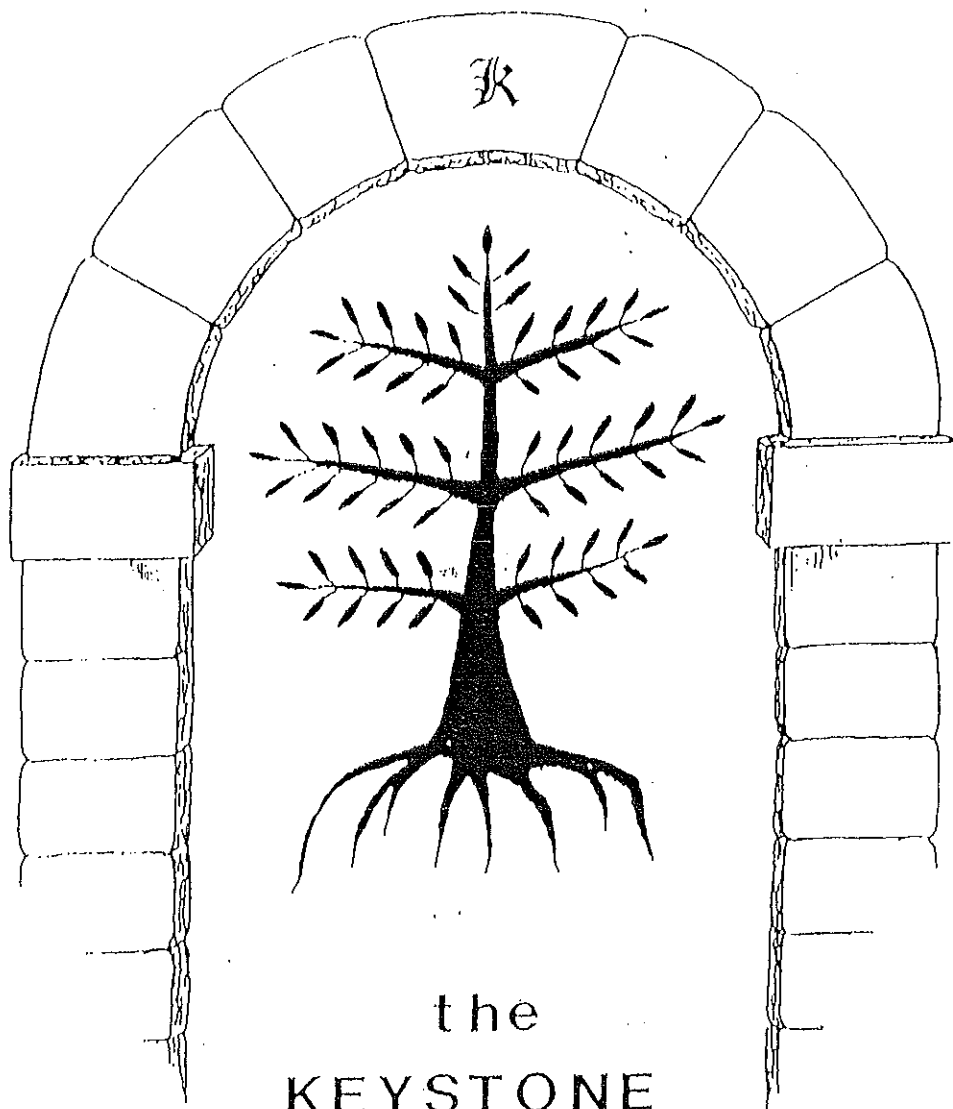

the  
KEYSTONE  
NEWSLETTER

Gaylord Fact Finders Genealogical Society

P. O. Box #1524

Gaylord, Michigan 49734

**GAYLORD FACT FINDERS GENEALOGICAL SOCIETY**  
P. O. BOX #1524  
GAYLORD, MICHIGAN 49734-5524

Volume 19, No. 3

January, 2006

**Officers for 2005 – 2006:**

President	Donna Marrs
Vice-President	Patricia Moehring
Recording Sec.	Mary "Dell" Krueger
Corresp. Sec.	Donna Marrs
Treasurer	Jackie Skinner
Past-President	Uilani Clifton
These officers and past-president comprise our Executive Board	

**Committees:**

Obits/Vital Records	Donna Marrs
Membership	Patricia Moehring
Social	Patricia Moehring
Newsletter	Donna Marrs Patricia Moehring

**Programs**

Inter-Society Liaison	Donna Marrs
MGC Delegates	Donna Marrs, Janet & Donald Rechlin

Publications	Sue Giessel
Historian	Patricia Moehring

Publisher of "**THE KEYSTONE**" is the Gaylord Fact Finders Genealogical Society, a non-profit organization. Publication is in January, April, July, and October. Annual dues are \$10.00 per individual) or \$12.00 per family), and are **DUE BY THE MAY MEETING EACH YEAR**. If the dues have not been received, that member will not receive the July issue of "**THE KEYSTONE**." Regular meetings are held on the third Wednesday of each month (August – November, and March – June) temporarily at the Otsego County Library, 700 S. Otsego, Gaylord, Michigan.

This issue contains the Library Corner; some good research web-sites; Beginning birth registration dates in Michigan by county; Up-coming events; continues land-owners of Otsego County, c. 1930; Marriages and divorces in Michigan; and locating graves when there is no headstone.

**DUES ARE PAYABLE IN MAY, 2006**

"FAMOUS FAMILIES OF MASSACHUSETTS"

Call 929.2Cra

By Mary Crawford

Contents include the families of:

Paine	Coffin	Otis
Jackson	Rotch	Lyman
Warren	Other Nantucket	Eliot
Holmes	families	Loring
Wigglesworth	Dexter	Choate
Wendell	Tuckerman	Sedgwick
Parkman	Appleton	Some Salem families
Frothingham	Lawrence	Bowditch
Hunnewell	Sargent	Three South Shore families
Durant	Bullfinch	Ames
Amory	Coolidge	Sears
Brooks	Phillips	Sigourney

~~~~~

New DAR Online Index.

The Daughters of the American Revolution (DAR) has enhanced its online index to the Genealogical Records Committee Reports (the name for its collection of genealogical information from family Bibles, Tombstones, church records, etc. You can search this 18-million name index for your ancestors at: [http://grc.dar.org/dar/darnet/grc/grc.cfm?Action=New\\_Search](http://grc.dar.org/dar/darnet/grc/grc.cfm?Action=New_Search)

The results will show you the book title and a link to its catalog record with the volume number and location in DAR's library. You'll also see the contents of the subject and notes fields, which can help you determine if the book is relevant to your research. Click "Ordering Page Copies" for details on requesting photocopies of the pages of interest.

The DAR, founded in 1890, is a volunteer women's service organization dedicated to promoting patriotism and preserving American history. As the most inclusive lineal society in America, the DAR boasts 170,000 members in 3,000 chapters across the United States and internationally. It has an outstanding genealogical library in Washington, D.C.

DUES ARE PAYABLE IN MAY, 2006

Initial Birth Registration by County, in Michigan

Michigan Vital Records were first recorded in 1867. However, not all counties adhered to this date.

Records beginning in 1867 include:

|                |            |            |
|----------------|------------|------------|
| Allegan        | Huron      | Menominee  |
| Alpena         | Ingham     | Midland    |
| Antrim         | Ionia      | Monroe     |
| Barry          | Iosco      | Montcalm   |
| Bay            | Isabella   | Muskegon   |
| Berrien        | Jackson    | Newaygo    |
| Branch         | Kalamazoo  | Oakland    |
| Calhoun        | Kent       | Oceana     |
| Cass           | Keweenaw   | Ontonagon  |
| Cheboygan      | Lapeer     | Ottawa     |
| Clinton        | Leelanau   | Sanilac    |
| Delta          | Lenawee    | Shiawassee |
| Eaton          | Livingston | St. Clair  |
| Emmet          | Macomb     | St. Joseph |
| Genesee        |            |            |
| Grand Traverse | Manistee   | Tuscola    |
| Gratiot        | Marquette  | Van Buren  |
| Hillsdale      | Mason      | Washtenaw  |
| Houghton       | Mecosta    | Wayne      |

Records beginning in 1868 include:  
Charlevoix

Saginaw Wexford

Records beginning in 1869 include:  
Alcona

Benzie  
Chippewa Osceola

Records beginning in 1870 include:  
Kalkaska

Lake  
Missaukee Schoolcraft

Records beginning in 1871 include:  
Clare

Manitou  
(1871 - 1893 ONLY) Presque Isle

Records beginning in 1873 include:

Mackinac

Records beginning in 1874 include:  
Baraga

Gladwin

Records beginning in 1875 include:

Otsego Roscommon

Records beginning in 1876 include:

Isle Royale ONLY for 1876

Records beginning in 1878 include:

Crawford Ogemaw

Records beginning in 1880 include:

Oscoda

Records beginning in 1881 include: Montmorency  
Records beginning in 1883 include: Arenac  
Records beginning in 1884 include: Alger  
Records beginning in 1885 include: Iron  
Records beginning in 1886 include: Gogebic Luce  
Records beginning in 1891 include: Dickinson

(This information was taken from the MGC Newsletter – Spring, 2005)

#### UP-COMING EVENTS:

April 27 – 29 Toledo, Ohio. Ohio Genealogical Society Annual Conference  
“Planting the Seed: Tools for Growing Your Family Tree” Radisson Hotel  
[www.ogs.org/2006conf.php](http://www.ogs.org/2006conf.php)  
June 7 – 10 Chicago, Illinois. The National Genealogical Society will hold the 2006  
Annual Conference “They Passed This Way” which includes more than 140  
lectures, workshops, luncheons and networking events.  
<http://www.ngsgenealogy.org/2006Chicago.cfm>

#### MICHIGAN FACTS:

With 40,001 square miles covered by water, Michigan is the wettest state in the contiguous United States. It has been estimated that on average, 400,000 gallons of rain and snow fall on Lake Michigan every second. And when in the state, it is impossible to go more than 5 miles before running into a lake or a stream.

#### CIVIL WAR PRINCIPALS AND SUBSTITUTES INDEX-----

This database at the Archives of Michigan lists the names of Michigan principal draftees and substitutes. It was created from original descriptive rolls of Civil War units. The Union established a draft with the 1863 Enrollment Act. Section 13 allowed draftees to avoid service by paying a \$300 commutation fee, or by hiring a substitute. The commutation rule was abandoned the following year, but substitutions continued for the duration of the war. CHECK OUT THE ARCHIVE OF MICHIGAN website:

[http://www.michigan.gov/hal/0,1607,7-160-17445\\_19273\\_19313-125416--,00-.html](http://www.michigan.gov/hal/0,1607,7-160-17445_19273_19313-125416--,00-.html)  
(from Flint Genealogical Society Newsletter Vol 28 #9, Dec, 2005)

CANADIAN 1911 CENSUS ON LINE at <http://www.genealogy.gc.ca/06/06-e.html>

“MICHIGAN GENEALOGIST” by Michigan History, Arts, and Libraries on line at:  
[www.michigan.gov/familyhistory](http://www.michigan.gov/familyhistory)

DUES ARE PAYABLE IN MAY, 2006

#### VETERANS' DAY:

In 1918 on the 11<sup>th</sup> hour of the 11 day of November (the 11<sup>th</sup> month) an armistice between the Allies and Germany was implemented to end World War I (WWI). This holiday is known as Remembrance Day in other parts of the world.

Ancestry.com announces completion of the WWI Draft Registration Card Collection, which contains about 24 million names. These cards are particularly useful because they represent everyone that registered for the draft, including many that never served in the military. The collection does not include all active military during this period, but 98 percent of men under the age of 46 in the U.S. completed a registration card in 1917 and 1918.

These cards often provide: Full name; home address; date and place of birth; age, race, and country of citizenship; occupation and employer, and physical description (hair and eye color, height, any disabilities). Other information that might be included is address of nearest or dependent relatives, marital status, father's birthplace, or previous exemption from military service, and his signature.

Subscribers to Ancestry.com will be able to access these valuable genealogical records. If you have an ancestor or relative who was between the ages of 18 and 45 in 1917 - 1918 (born ca. 1872 - 1900), you may be able to find him in this database. <http://www.ancestry.com/>

#### U.S. LAND RECORDS BACK ON-LINE:

The Bureau of Land Management, Eastern States recently announced that its General Land Office (GLO) Records website is back on line at <http://www.glorerecords.blm.gov/>

Title companies, historians, genealogists, and other interested people can once again obtain millions of historic land title records from the 30 Public Land States (those states not included in the original 13 Colonies) dating back to the 1780s. These fascinating and valuable records include homesteads, patents, military warrants, and railroad grants. So far, more than 4.2 million records have been scanned and imaged since the project began in 1989.

"The GLO Records Web-site is one of the most popular websites at the Department of the Interior. It offers customers the ability to research and query the GLO database by name, land description, and county, and view and print these history documents from their homes or offices, saving them time and money. We at BLM recognize the impact that the temporary disconnection has had on our customers, and we thank them for their patience and understanding during this period," said BLM-Eastern States Director Mike Nedd.  
(From RootsWeb.com)

#### MORE HELPFUL WEB-SITES:

A rare 1883 atlas of the German Empire has been digitized by the Memorial Library at the University of Wisconsin-Madison and is in searchable format online --

[www.library.wisc.edu/etext/ravenstein](http://www.library.wisc.edu/etext/ravenstein)

A website to help people find what county a city is in, or a specific county in a state --

[www.hometownlocator.com/](http://www.hometownlocator.com/)

New York Public Library has put online more than 360,000 images of its Digital Gallery, including Ellis Island photographs, maps, Civil War photos, various city scenes, Native American pictures, etc. These images can be downloaded free for personal use. Use of the images for publication, or in film, television, or Internet can be arranged through the library's "Permission Dept."

<http://digitalgallery.nypl.org/>

# T30N. PART OF CHESTER R2W.

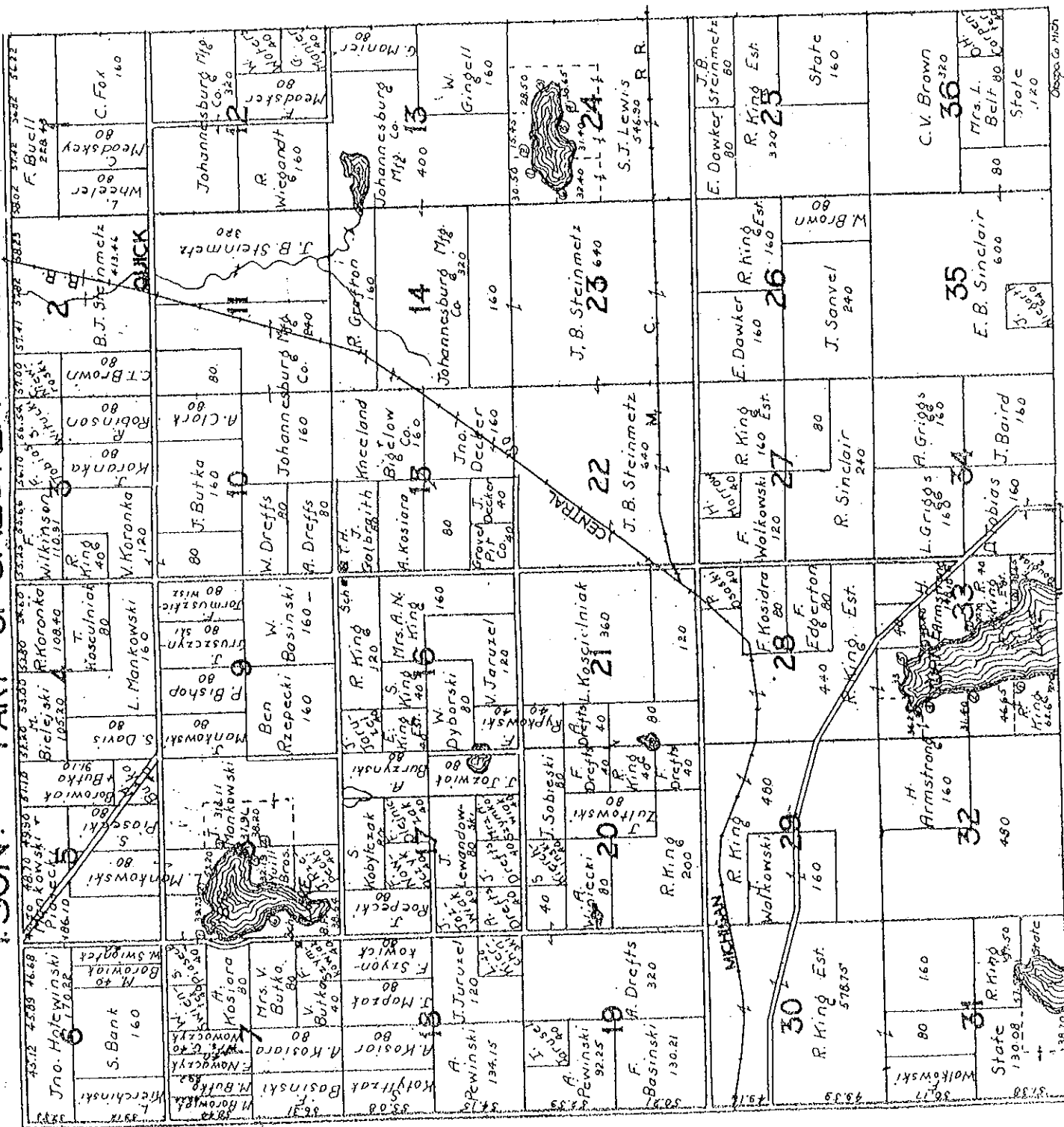

LAND OWNERS OF OTSEGO COUNTY, MICHIGAN, C. 1930  
CHESTER TOWNSHIP (last part of) T30N, R2W

- Section 19 - A. Drefts - 320 acres  
F. Basinski - 130.21 acres  
A. Pewinski - 92.25 acres  
I. Jweuawl - 40 acres
- Section 20 - A. Drefts - 40 acres  
S. Kierchsinski - 40 acres  
J. Sobieski - 80 acres  
A. Winiecki - 80 acres  
J. Zultowski - 80 acres  
F. Drefts - 80 acres  
R. King - 240 acres
- Section 21 - F. Rypkowski - 40 acres  
A. Drefts - 40 acres  
F. Drefts - 80 acres  
L. Koscielniak - 160 acres  
J. B. Steinmetz - 120 acres
- Section 22 - J. B. Steinmetz - 640 acres
- Section 23 - J. B. Steinmetz - 640 acres
- Section 24 - S. J. Lewis - 546.30 acres
- Section 25 - E. Dowker - 80 acres  
J. B. Steinmetz - 80 acres  
R. King Estate - 320 acres  
State of Michigan - 160 acres
- Section 26 - R. King Estate - 160 acres  
E. Dowker - 160 acres  
J. Sanvel - 240 acres  
W. Brown - 80 acres
- Section 27 - R. King Estate - 160 acres  
H. Marrow - 40 acres  
F. Walkowski - 120 acres  
R. Sinclair - 320 acres
- Section 28 - P. Ososki - 40 acres  
F. Kosidra - 80 acres  
F. Edgerton - 80 acres  
R. King Estate - 440 acres
- Section 29 - R. King - 480 acres  
J. Walkowski - 160 acres
- Section 30 - R. King Estate - 578.74 acres
- Section 31 - R. King Estate - 240 acres  
F. Walkowski - 50.17 acres  
State of Michigan - 130.08 acres  
R. King - 115 acres
- Section 32 - H. Armstrong - 160 acres  
R. King Estate - 480 acres
- Section 33 - H. Armstrong - 148.10 acres  
A. Douglas - 38.60 acres  
R. King Estate - 453.30 acres
- Section 34 - L. Griggs - 160 acres  
A. Griggs - 160 acres  
D. Tobias - 160 acres  
J. Baird - 160 acres
- Section 35 - E. B. Sinclair - 600 acres  
J. Niegarth - 40 acres

Section 36 - C. W. Brown - 320 acres  
E. B. Sinclair - 80 acres  
Mrs. L. Belt - 80 acres  
O. H. Carpenter - 40 acres  
State of Michigan - 120 acres

(To be continued in next issue)

#### MARRIAGE AND DIVORCE IN MICHIGAN-----

County clerks began recording marriages as early as 1815. State registration began in 1867 and is kept at the Department of Public Health in Lansing. In 1887 county clerks were required to issue and record marriage licenses. There is an index to marriages and divorces, 1867 - 1914, at the Library of Michigan in Lansing. Many county records have been filmed. See also indexes, such as Grand Rapids Public Library Brides' Baner Index 1850-69 (film 1002012) at the Public Library in Grand Rapids which includes grooms' names and marriage dates. Most are Kent County marriages, but some are from other counties in Michigan.

The earliest divorces were recorded in the acts of the Michigan Territorial Legislature, 1805-12. See Laws of the Territory of Michigan (Lansing: W.S. George, 1871). After that time divorces were granted by the Supreme Court, followed in jurisdiction by the county chancery and circuit courts. The Supreme Court cases, 1819-58 (film 09558719 ff.) are at the Bentley Library, University of Michigan, in Lansing.

\*\*\*\*\*

ADDITIONAL FEDERAL RECORDS FOR NATIVE AMERICANS AND AFRICAN AMERICANS--  
The Records of the Bureau of Indian Affairs (RG 75) contain registers of marriage and divorces for many states. Most of these records have been filmed. The Records of the Bureau of Refugees, Freedmen, and Abandoned Lands (RG 105) also contain marriage records and have been filmed. (both of the above were printed in Everton's Genealogical Helper, Jan-Feb, 1999)

#### ~~~~~ LOCATING GRAVES

The first time that I ever heard of dowsing for graves was in 1984 in the State of Indiana. They had moved the old folks' home graveyard to make way for a road and there were no tombstones. How did someone find the graves? They dowsed. How do you dowse, you ask?

Take two metal hangers and cut yourself an "L" shape from both. Go to a cemetery that you know of, and try it there first. If you can document this on film, that would be great, and take several witnesses with you. Don't forget to let them try, though you may not want to give up the rods after you try it yourself a couple times.

Hold the hangers in front of you by the short ends, like you are ready to box someone, with the long ends sticking straight in front of you. You don't want to hold them firm, but not dangling from your fists either. Now, walk across a row of graves that you know are there. WOW! The first time is a shocker. The rods will cross in front of you at even intervals for each grave as you walk at a steady pace across them. Do you see how the rods will cross and identify the grave? Don't forget to take the video camera with you when you go out to the farm then. You want to record finding the graves, and you will need to make a grid map of where the graves lie.

Using this method, you should be able to identify where all the graves in a cemetery lie. If the rods do the opposite, go out instead of crossing. BINGO! You have water. I have had that happen once. Really shocked me.

(e-mail from [sarahreveley@grandecom.net](mailto:sarahreveley@grandecom.net) May 18, 2005)

SPELLING TRIVIA-----

If "gh" = "p" as in hiccough,

If "ough" = "o" as in dough,

If "phth" = "t" as in phthisis,

If "eigh" = "a" as in neighbor,

If "tte" = "t" as in gazette,

If "eau" - "o" as in plateau-----

"potato" should be "ghoughphtheightteau"

(Michigan DAR newsletter, Vol 28, #3, 9/2000)

DUES ARE PAYABLE IN MAY, 2006

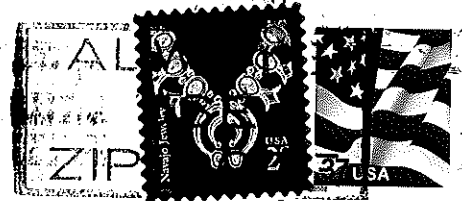
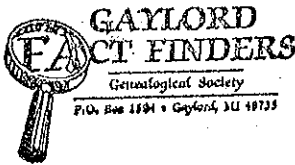

Otsego County Library  
700 So. Otsego  
Gaylord, MI 49735

